

## Streetlight Connectors

### TYPE: SLWB/SLOWB Submersible Streetlight Connector

- Designed for use in Submersible installations such as handholes and below grade boxes
- Insulated with High Dielectric Strength Plastisol
- Molded for precise fit and supplied with removeable access plugs over the hex screws
- Eliminates the need for cover and taping
- Abrasion and chemical resistant
- Will not support combustion
- Cold Temperature Rated to -45° C



Rocket is used for wire sizes #1 - 14 AWG

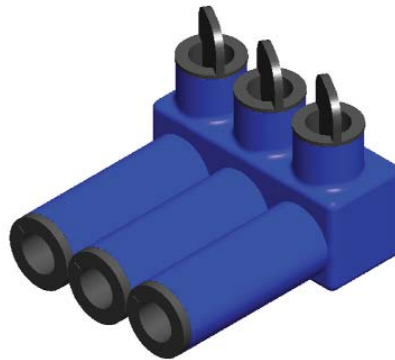
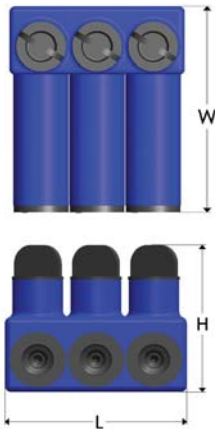

Figure 1

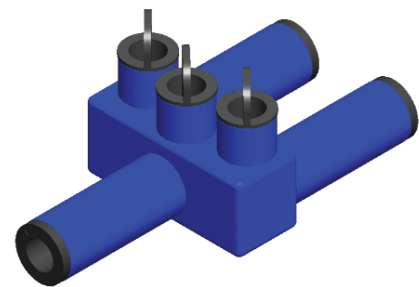

Figure 2

| Catalog Number | Number of Ports | Figure Number | Wire Range AWG | Wire Range MM | Hex Size | Dimensions, Inches |      |      |
|----------------|-----------------|---------------|----------------|---------------|----------|--------------------|------|------|
|                |                 |               |                |               |          | H                  | W    | L    |
| SLWB2/0-2      | 2               | 1             | 2/0-14         | 70 - 2.5      | 3/16     | 2.13               | 2.75 | 1.80 |
| SLWB2/0-3      | 3               | 1             | 2/0-14         | 70 - 2.5      | 3/16     | 2.13               | 2.75 | 2.65 |
| SLWB2/0-4      | 4               | 1             | 2/0-14         | 70 - 2.5      | 3/16     | 2.13               | 2.75 | 3.49 |
| SLWB2/0-5      | 5               | 1             | 2/0-14         | 70 - 2.5      | 3/16     | 2.13               | 2.75 | 4.33 |
| SLWB2/0-6      | 6               | 1             | 2/0-14         | 70 - 2.5      | 3/16     | 2.13               | 2.75 | 5.17 |
| SLWB2/0-7      | 7               | 1             | 2/0-14         | 70 - 2.5      | 3/16     | 2.13               | 2.75 | 6.01 |
| SLWB2/0-8      | 8               | 1             | 2/0-14         | 70 - 2.5      | 3/16     | 2.13               | 2.75 | 6.85 |
| SLWB2/0-9      | 9               | 1             | 2/0-14         | 70 - 2.5      | 3/16     | 2.13               | 2.75 | 7.69 |
| SLWB2/0-10     | 10              | 1             | 2/0-14         | 70 - 2.5      | 3/16     | 2.13               | 2.75 | 8.53 |
| SLOWB2/0-21    | 3               | 2             | 2/0-14         | 70 - 2.5      | 3/16     | 2.13               | 4.25 | 2.65 |
| SLOWB2/0-22    | 4               | 2             | 2/0-14         | 70 - 2.5      | 3/16     | 2.13               | 4.25 | 3.49 |
| SLOWB2/0-31    | 4               | 2             | 2/0-14         | 70 - 2.5      | 3/16     | 2.13               | 4.25 | 3.49 |
| SLOWB2/0-32    | 5               | 2             | 2/0-14         | 70 - 2.5      | 3/16     | 2.13               | 4.25 | 4.33 |
| SLOWB2/0-33    | 6               | 2             | 2/0-14         | 70 - 2.5      | 3/16     | 2.13               | 4.25 | 5.17 |
| SLOWB2/0-42    | 6               | 2             | 2/0-14         | 70 - 2.5      | 3/16     | 2.13               | 4.25 | 5.17 |

\* Connector is used without Rockets for wire sizes 2/0-1/0 AWG

• Inverted Rocket is used for wire sizes #1-14 AWG